

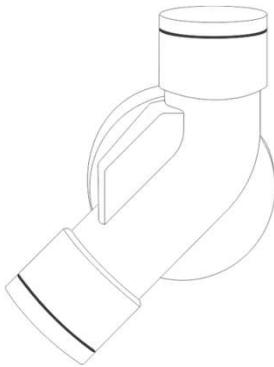

Technical Specification QF Universal Connector



General Description

The QF trap is designed to be installed on a universal connector. The trap is designed for low flow applications such as line drainage and trace heating. The trap has an integral strainer and removable nozzle. The body of the trap does not have to be removed for maintenance purposes.

Dimensions

A	B	C	Weight (approx.)
4.17" (106 mm)	4.72" (120 mm)	2.05" (52 mm)	3.2 lb (1.45 kg)

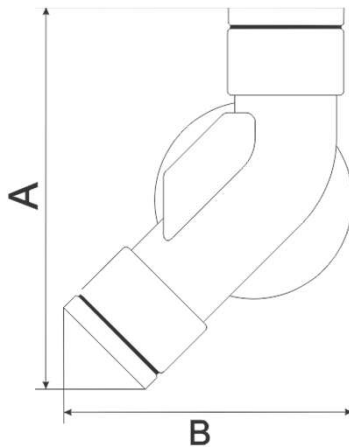

Operating Parameters (ISO 6552:1980)

PMA 1450 psig (100 barg)
 TMA 1022°F (550 °C)
 PMO 435 psig (30 barg) @ 500 °F (260°C)
 TMO 572°F (300 °C) @ 0 psig (0 barg)
 Cold tested to 2175 psig (150 barg)

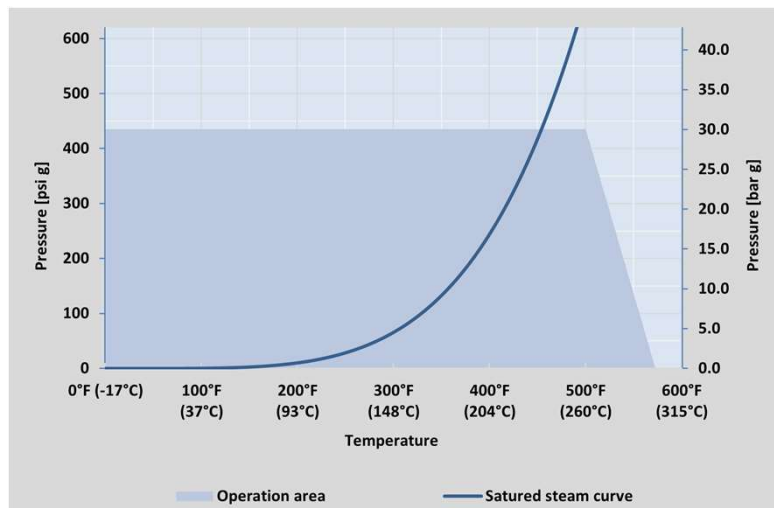
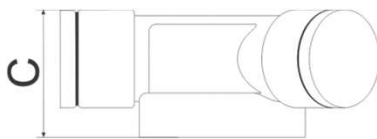

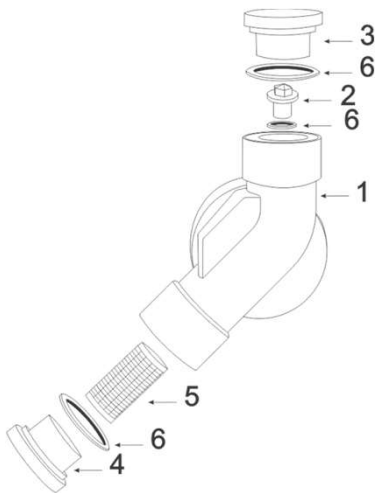

Construction

No.	Part	Material
1	Cast stainless steel body	CF8M
2	Removable nozzle	304L stainless steel
3	Nozzle cap	316 stainless steel
4	Strainer cap	304L stainless steel
5	Strainer filter	50 mesh stainless steel
6	Gaskets	Graphite composite

Options

- Blow down valve available for periodic cleaning of the filter (PMO dependent)
- Universal connector available in 1/2" (DN15) and 3/4" (DN20)

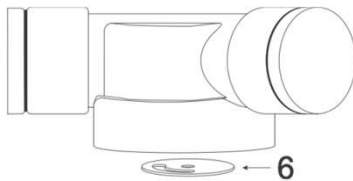

Spare parts

Part	Code
Strainer Filter	F-S
Cap Gasket	GT-4
Nozzle Gasket	GT-1